

## Screw-on sight glass

Screw-on sight glass similar to DIN 11851 for tube diameters acc. to DIN EN 10357, with round glass plates for visual inspection. The threaded fittings can be welded on.

**Available for aseptic applications acc. DIN 11864-1**

### Application:

For visual inspection of the inside of bioreactors, laboratory blenders, filtration devices, boilers, tanks, agitators, separators, tubes and other containers which are usually closed.

Particularly suitable for pharmacy or food industry e.g. dairy plants or breweries.

### Operating conditions:

Max. 6 bar (higher pressure rates upon request),  
Vacuum

### Temperatures:

Temperature for use with flat sealing surfaces with flat gasket see temperature diagram.

### Accessories:

Can be used with several LED luminaires. From DN 50 on a wiper SW 1 type can be mounted. A combination of LED luminaires and wiper is possible from DN 125 on.

### Parts and materials:

Pos.	Part	Material
1	Union-nut	St. steel 1.4301 (1.4307)
2	Flat gasket	KLINGERSIL C-4400
3	Glass plate	Soda lime glass thermally toughened, DIN 8902, max. 150°C; Borosilicate glass thermally toughened DIN 7080, max. 280°C
4	O-Ring ( <i>max. temp. see diagram</i> )	Viton, PTFE, Perbunan, Silikon, EPDM
5	Connecting piece	St. steel 1.4301 (1.4307); 1.4404
6	Vessel wall	

(Temperature diagram for material selection)

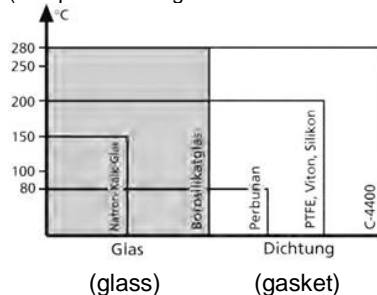

Complete unit of screw-on sight glass

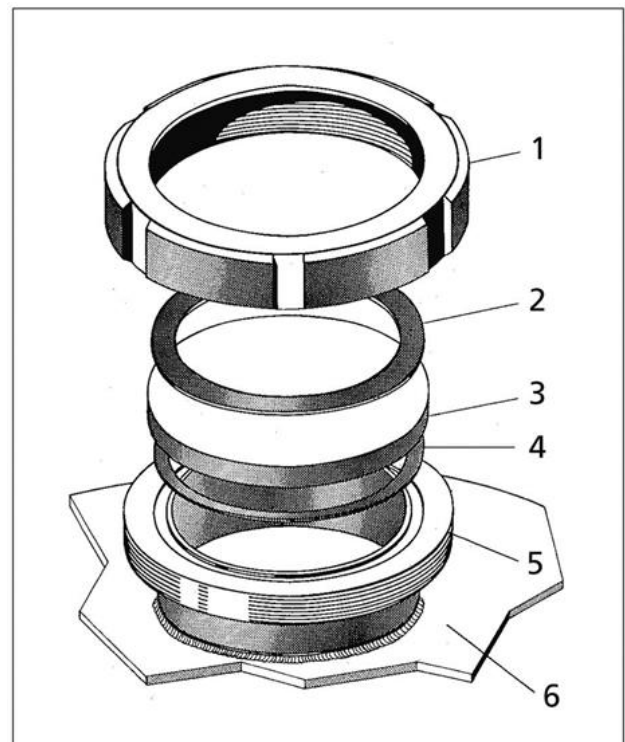

Components of screw-on sight glass

### Mounting:

After welding the connection piece (5) onto the vessel wall (6), gasket (4), glass plate (3) and flat gasket (2) will be placed as shown in the picture und will be screwed on with the union nut (1) connecting to the connection piece (5) firmly.

### Caution:

Please double-check that the glass plate is lying flat and is correctly centered.

Subject to change (without notice)

**Dimensions:**

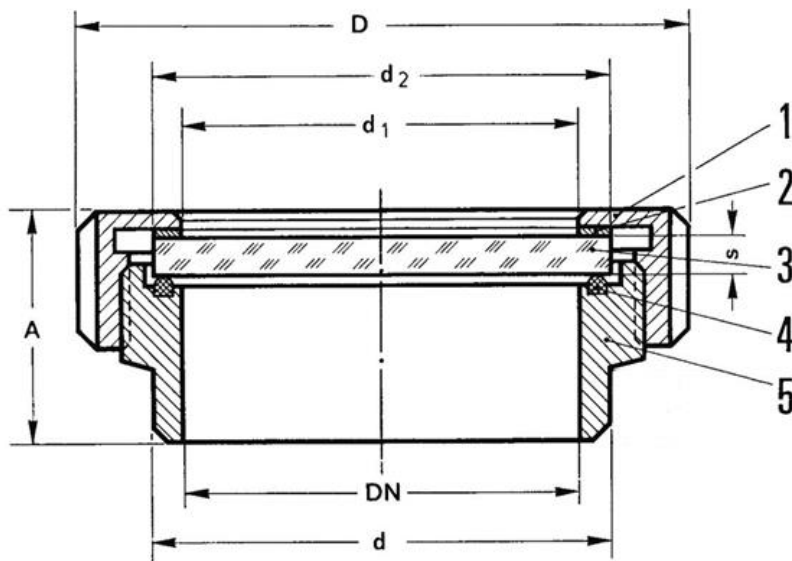

Nominal width	DN	32	40	50	65	80	100	125	150
Visible area	d <sub>1</sub>	32	40	50	65	80	100	125	150
Glass plate	d <sub>2</sub>	50	55	63	80	100	117	150	175
	s	10	10	10	12	15	15	20	20
Sight glass unit	D	70	78	92	112	127	148	178	210
	d	35	41	53	69	84	104	129	154
	A	40	41	44	52	57	69	59	62

**Order information:**

- Screw -on sight glass similar to DIN 11851
- Nominal width: DN 80 PN 6 bar
- Please specify materials for:
  - Union nut (only 1.4301)
  - Connecting piece
  - Glass plate
  - Gaskets

Subject to change (without notice)